

PRODUCT INFORMATION PACKET

Model No: 048A17T2003
Catalog No: X025
1/3,1625,TENV,48Z,1/60/115/230
Single Phase



Regal and Marathon are trademarks of Regal Beloit Corporation or one of its affiliated companies.
©2018 Regal Beloit Corporation, All Rights Reserved. MC017097E





Nameplate Specifications

Output HP	0.33 Hp	Output KW	0.25 kW
Frequency	60 Hz	Voltage	115/230 V
Current	4.2/2.1 A	Speed	1625 rpm
Service Factor	1	Phase	1
Efficiency	0 %	Duty	Continuous
Insulation Class	B	Design Code	NO DESIGN CODE
KVA Code	G	Frame	48Z
Enclosure	Totally Enclosed Air Over	Overload Protector	Auto Lock Rotor Only
Ambient Temperature	40 °C	Drive End Bearing Size	6203
Opp Drive End Bearing Size	6203	UL	Recognized
CSA	Y	CE	N
IP Code	43		

Technical Specifications

Electrical Type	Permanent Split Capacitor	Starting Method	Across The Line
Poles	4	Rotation	Selective Counterclockwise
Mounting	Resilient Base - Extended Studs	Motor Orientation	Horizontal
Drive End Bearing	Ball	Opp Drive End Bearing	Ball
Frame Material	Rolled Steel	Shaft Type	Single Special Extension
Overall Length	10.09 in	Frame Length	5.50 in
Shaft Diameter	0.500 in	Shaft Extension	2.56 in
Assembly/Box Mounting	F1 Only		
Outline Drawing	A-SS75967-550	Connection Diagram	A-EE9057T

This is an uncontrolled document once printed or downloaded and is subject to change without notice. Date Created: 06/29/2018

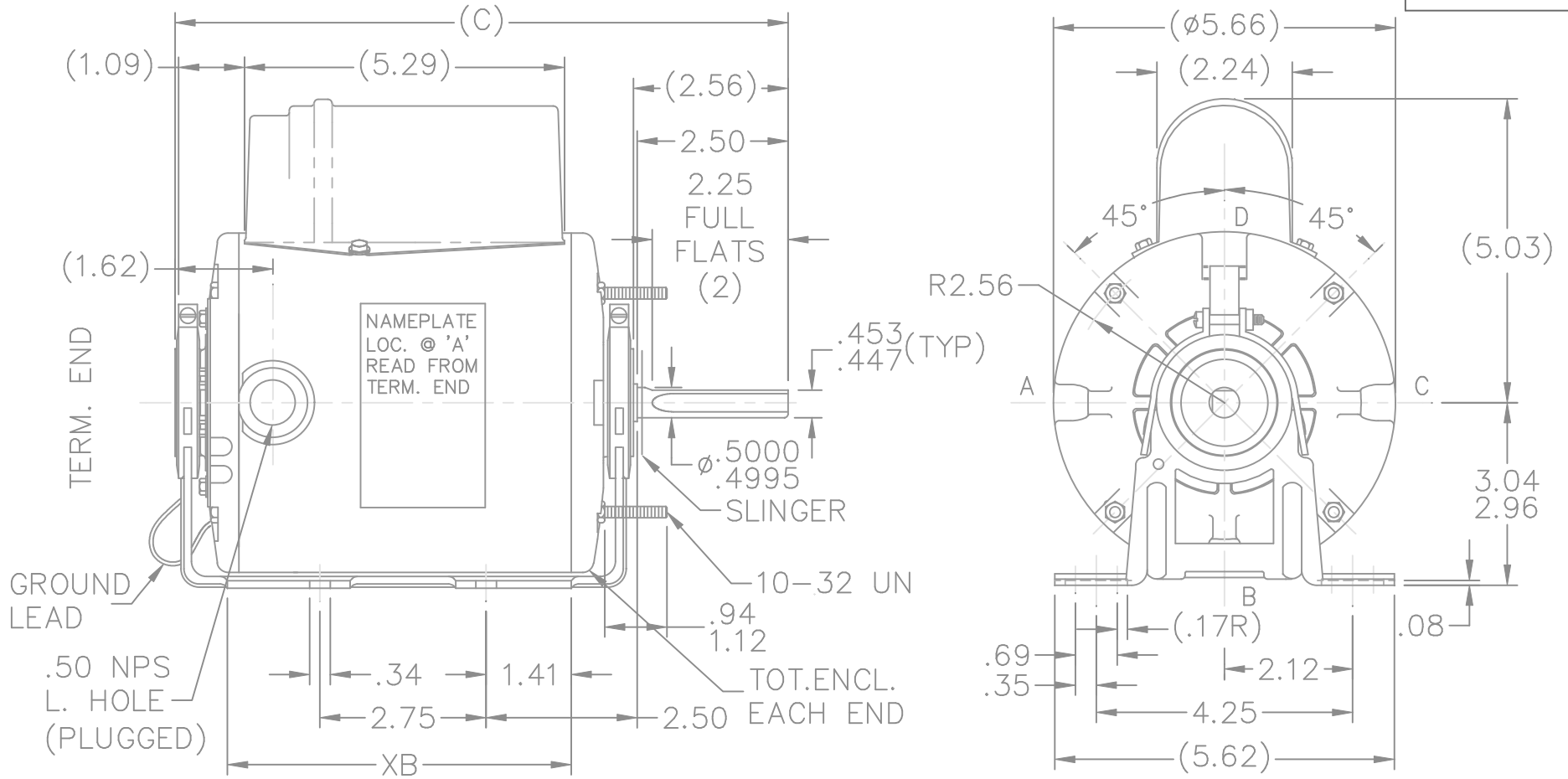

DASH	FR	XB	C
550	48	5.69	10.09
625	48	6.44	10.84

TOTALLY ENCLOSED MOTOR
FULLY GASKETED

				TOLERANCES UNLESS SPECIFIED		MARATHON ELECTRIC	DRAWN DD 01-14-1994				
				DEC.	INCHES		CHK ML 01-17-1994	APPD SHT 01-17-1994			
3	UPDATED DRAWING	TJW	04/23/2007	.XX	±.03	TITLE OUTLINE	SCALE 3=8				
2	REDRAWN IN AUTOCAD	TAT	05-09-2005	ML	.XXX ±.005		REF				
1	NEW DRAWING 4109227	DD	01-21-1994	.XXXX	±.0005		MAT'L	FMF			
NO.	REVISION	BY & DATE	CHK	ANG	±7'30"	FINISH	PREV				
THIS DRAWING IN DESIGN AND DETAIL IS OUR PROPERTY AND MUST NOT BE USED EXCEPT IN CONNECTION WITH OUR WORK ALL RIGHTS OF DESIGN AND INVENTION ARE RESERVED THIS IS AN ELECTRONICALLY GENERATED DOCUMENT - DO NOT SCALE THIS PRINT				RFP		CAD FILE ss75967	SIZE A	DRAWING NO. SS75967	PAGE	OF	REV. 3
				DIST	WP						

DUAL VOLTS

CCW ROTATION, LEAD END, SHOWN TO REVERSE EITHER VOLTAGE INTERCHANGE RED AND BLACK LEADS.

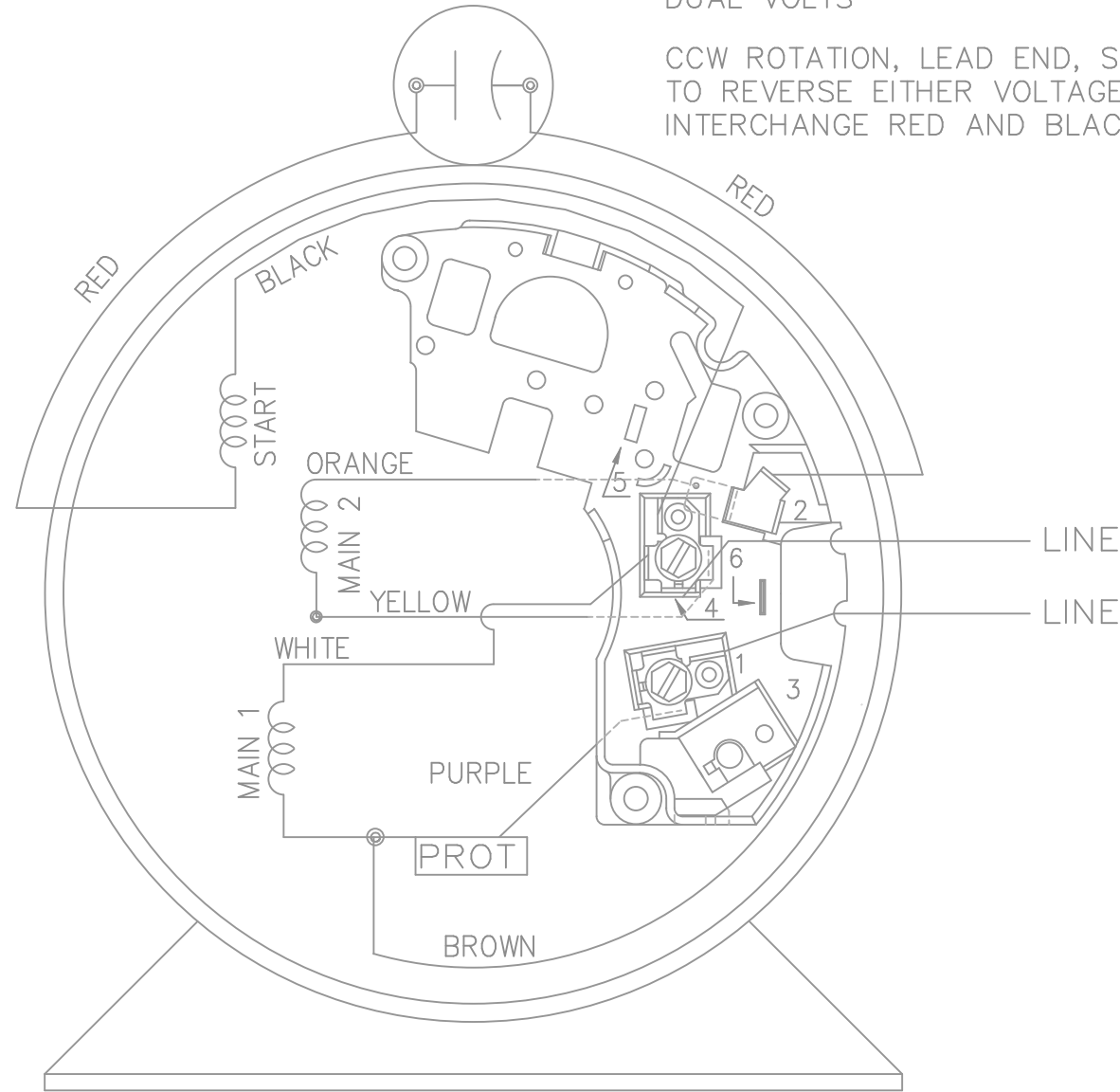

LOW VOLTAGE

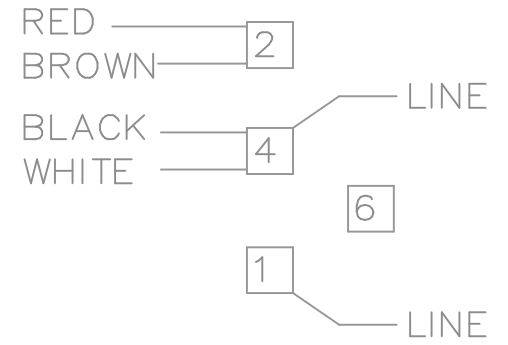

HIGH VOLTAGE

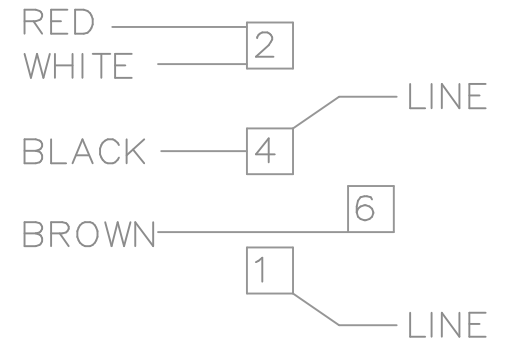

VIEW OF TERMINAL END

			TOLERANCES UNLESS SPECIFIED			DRAWN RM 02-21-1992				
			DEC.	INCHES		CHK ML 09-21-1992				
			.X	± -		APPD GK 09-23-1992				
3	REDRAWN IN AUTOCAD	NJS	.XX	± -	TITLE CONNECTION DIAGRAM	SCALE 1=1				
2	ADDED ROTATION CN 23975-249	MH 04-07-1998	.XXX	± -		REF				
1	NEW DRAWING CN 14642	RM 09-23-1992	.XXXX	± -	MAT'L.	FMF				
NO.	REVISION	BY & DATE	CHK	ANG ± -		FINISH	PREV			
THIS DRAWING IN DESIGN AND DETAIL IS OUR PROPERTY AND MUST NOT BE USED EXCEPT IN CONNECTION WITH OUR WORK ALL RIGHTS OF DESIGN AND INVENTION ARE RESERVED THIS IS AN ELECTRONICALLY GENERATED DOCUMENT - DO NOT SCALE THIS PRINT			RFP		CAD FILE EE9057T	SIZE A	DRAWING NO. EE9057T	PAGE	OF	REV. 3
			DIST	WP						

FORM 3531 REV.3 02/07/99

** Subject to change without notice.